

# Gull Landing



**3 Bedroom - 2 1/2 Bath**



First Floor 1088 sq.ft.  
Second Floor 741 sq.ft.

**TOTAL 1829 sq.ft.**  
Garage 624 sq.ft.  
Porch 240 sq.ft.

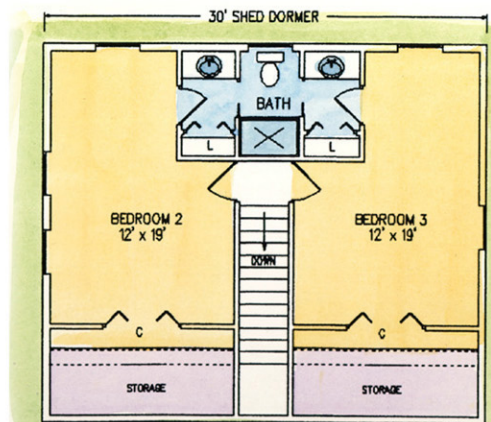

**BK**  
*Cypress*  
LOG HOMES

**Bronson, FL.**  
**1-800-553-1564**  
[www.bkcypress.com](http://www.bkcypress.com)